

ELECTRIC FORKLIFT TRUCK SERIES N 08-10

CAPACITY 800 - 1.000 KG
CENTER OF GRAVITY 500MM
VOLTAGE 48V

THE FIRST FORKLIFT
IN THE WORLD WITH
ELECTRIC
POWER STEERING.
WITH A COMFORTABLE
DRIVING POSITION,
IT IS SMALL,
HANDY AND POWERFUL.

N

carer

Electric Forklift Trucks



MAIN FEATURES

LOAD CAPACITY Kg 800 - 1000
CENTER OF GRAVITY 500mm
VOLTAGE 48V
WIDTH 850 mm
TYRES SE – C
REAR TWIN TYRES
2 FRONT TRACTION MOTORS
FULL AC
MULTIFUNCTION DISPLAY
ELECTRIC STEERING
ELECTRO HYDRAULIC BRAKE
BATTERY 48V – Maximum capacity 375Ah

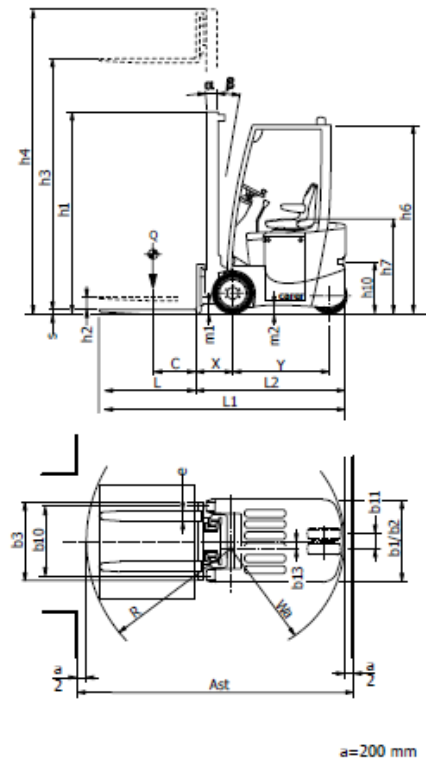

The benefits of choosing CARER



Really compact forklift width 85cm, voltage 48V, 2 ac traction motors, electric steering, rear twin superelastic tyres are some of the features that make the series N08-10 the most advanced in the industry. The compact dimensions and the two front traction powerfull motors

allow you to operate in confined spaces inside containers or wagons, and to work on ramps even in low-grip conditions.

The new technology used for the electric steering system allows to automatically reduce the speed on a bend, to adjust the sensitivity of the steering wheel and to optimize the energy consumption.

The comfortable driving position, the high visibility masts and the proper display position, that it shows all the functions and the diagnostics of the forklift, allow the driver to have always under control all the features taking care of the load and also to adjust the seat position to the specific needs of every operator.

The advanced AC motors and electronic system without mainte-

nance, are protected against dust and water infiltration.

The battery with capacity up to 375 Ah and the energy regeneration system allow to guarantee long working time and to reduce the recharging intervals.

A wide range of accessories allows you to customize the forklift to the specific handling requirements.



		C.A.R.E.R. Srl		
IDENTIFICATION	1.1	Manufacturer		
	1.2	Manufacturer's type designation		N08
	1.3	Drive		electric
	1.4	Operator type		seat
	1.5	Load capacity/rated load	Q (t)	0,8
	1.6	Load centre distance	C (mm)	500
	1.8	Load distance	X (mm)	365 (1) (2)
	1.9	Wheelbase	Y (mm)	1000
WEIGHTS	2.1	Weight	(kg)	2400
	2.2	Axle loading, laden front / rear	(kg)	2800 / 400
	2.3	Axle loading, unladen front / rear	(kg)	1310 / 1090
WHEELS	3.1	Tyres type		C-SE
	3.2	Tyre size, front		413x152 16x6-8
	3.3	Tyre size, rear		375x110 15x4½-8
	3.5	Wheels, number front rear (x = driven wheels)		2X/2
	3.6	Track width, front	b10 (mm)	698 698
	3.7	Track width, rear	b11 (mm)	160 160
DIMENSIONS	4.1	Tilt of mast / fork carriage forward / backward	α/β (°)	5/5(2)
	4.2	Closed mast height	h1 (mm)	2190
	4.3	Free lift	h2 (mm)	0
	4.4	Lift (standard mast)	h3 (mm)	3200
	4.5	Height, mast extended	h4 (mm)	3790
	4.7	Height of overhead guard	h6 (mm)	1975
	4.8	Seat height	h7 (mm)	980
	4.12	Coupling height	h10 (mm)	440
	4.19	Overall length	L1 (mm)	2535
	4.20	Length to face of forks	L2 (mm)	1535
	4.21	Overall width	b1/b2 (mm)	850 850
	4.22	Fork dimensions	exsXL (mm)	100x35x1000
	4.23	Fork carriage iso 2328/30, FEM/A,B		2A
	4.24	Fork-carriage width	b3 (mm)	800
	4.31	Ground clearance, laden, below mast	m1 (mm)	50
	4.32	Ground clearance, centre of wheelbase	m2 (mm)	75
4.33	Aisle width for pallets 1000x1200 crossways	Ast (mm)	2840	
4.34	Aisle width for pallets 800x1200 lengthways	Ast (mm)	2960	
4.35	Turning radius	Wa (mm)	1150	
4.36	Internal turning radius	b13 (mm)	0	
PERFORMANCE	5.1	Travel speed, laden / unladen	(km/h)	12/13
	5.2	Lift speed, laden / unladen	(m/s)	0,3/0,4
	5.3	Lowering speed, laden / unladen	(m/s)	0,5/0,4
	5.5	Drawbar pull, laden / unladen (S2 60')	(N)	1100 / 1250
	5.6	Max. drawbar pull, laden / unladen (S2 5')	(N)	3400 / 3550
	5.7	Gradeability, laden / unladen (S2 30')	(%)	6 / 9
	5.8	Max. gradeability, laden / unladen (S2 5')	(%)	12 / 17
	5.9	Acceleration time, laden / unladen (10 m)	(s)	5,5 / 5
	5.10	Service brake: mech./hydr./electr.		hydraulic/electric
	MOTOR /BATT.	6.1	Drive motor rating (S2 60')	(kW)
6.2		Lift motor rating (S3 20%)	(kW)	5,5
6.4		Battery voltage	U (V)	48
6.4.1		Rated capacity	K5 (Ah)	315 / 375
6.5		Battery weight minimum/maximum	(kg)	560 / 600
OTHERS	8.1	Type of drive control		inverter
	8.2	Operating pressure for attachments	(bar)	180
	8.4	Sound level at the driver's ear	(dBA)	-

VDI 2198

Rev00 06/12/2013

(1)With side-shifter integrated in the mast

(2)Depending on kind of mast

Wheels tyre legend: SE super elastic - SEGEM super elastic twins - C cushion - L pneumatic - VLK vulkolan

The performance data refer to a forklift truck in perfect working condition, with battery weight corresponding to the values given in 6.5

In accordance with VDI Guideline 2198 this specification sheet provides details of the standard truck only. Non-standard tyres, different masts, optional equipment, etc. may result in different values.

The C.A.R.E.R. products and specifications are subject to change without notice



C.A.R.E.R. Srl
Via Copernico 13
48010 Cotignola (RA) Italia
Tel. +39 0545 1938010
Fax +39 0545 908070
info@carerforklift.com
www.carerforklift.com